

COLUMN SCHEDULE

SL. No.	COLUMN TYPE	NO OF COLUMN	COLUMN SIZE	REINFORCEMENT VERTICALS	STIRRUPS	COLUMN SHAPE	TIES PROFILE
01.	C1	12	300 x 300	-	-		
02.	C2	12	300 x 450	-	-		
03.	C3	12	300 x 450	-	-		
04.	C4	12	300 x 450	-	-		
05.	C5	12	300 x 600	-	-		
06.	C6	12	300 x 600	-	-		
07.	C7	12	300 x 600	-	-		
08.	C8	12	300 x 750	-	-		
09.	C9	12	230 x 600	-	-		

FOOTING SCHEDULE :-

TYPE	NO. OF FOOTING	FOOTING SIZE	DEPTH D	PEDESTAL W x B	REINFORCEMENT (PAD)		SKIN BAR	
					TOP (B/W)	BOTTOM (B/W)		
F1	02	1200 x 1350	375	-	-	-	-	
F2	01	1500 x 1800	450	-	-	-	-	
F3	07	1800 x 1950	450	-	-	-	-	
F4	07	1950 x 2100	600	-	-	-	-	
F5/P	11	2100 x 2250	-	900 X 900	-	-	-	
F6/P	09	2400 x 2550	-	900 X 900	-	-	-	
F7/P	09	2700 x 2850	-	900 X 900	-	-	-	
LIFT PIT	1	2700 x 4800	REFER CROSS SECTION					

NOTES

- This drawing is sole property of 'Pithavadian and Partners' and must not be reproduced or altered either in full or in part by anyone without consent from us or be passed to any individual or company not authorised by us.
- Any discrepancy in the drawing should be brought to the immediate attention of the Architect.
- All dimensions in millimeters and levels in meters.
- Dimensions to be followed as indicated and not to be scaled.

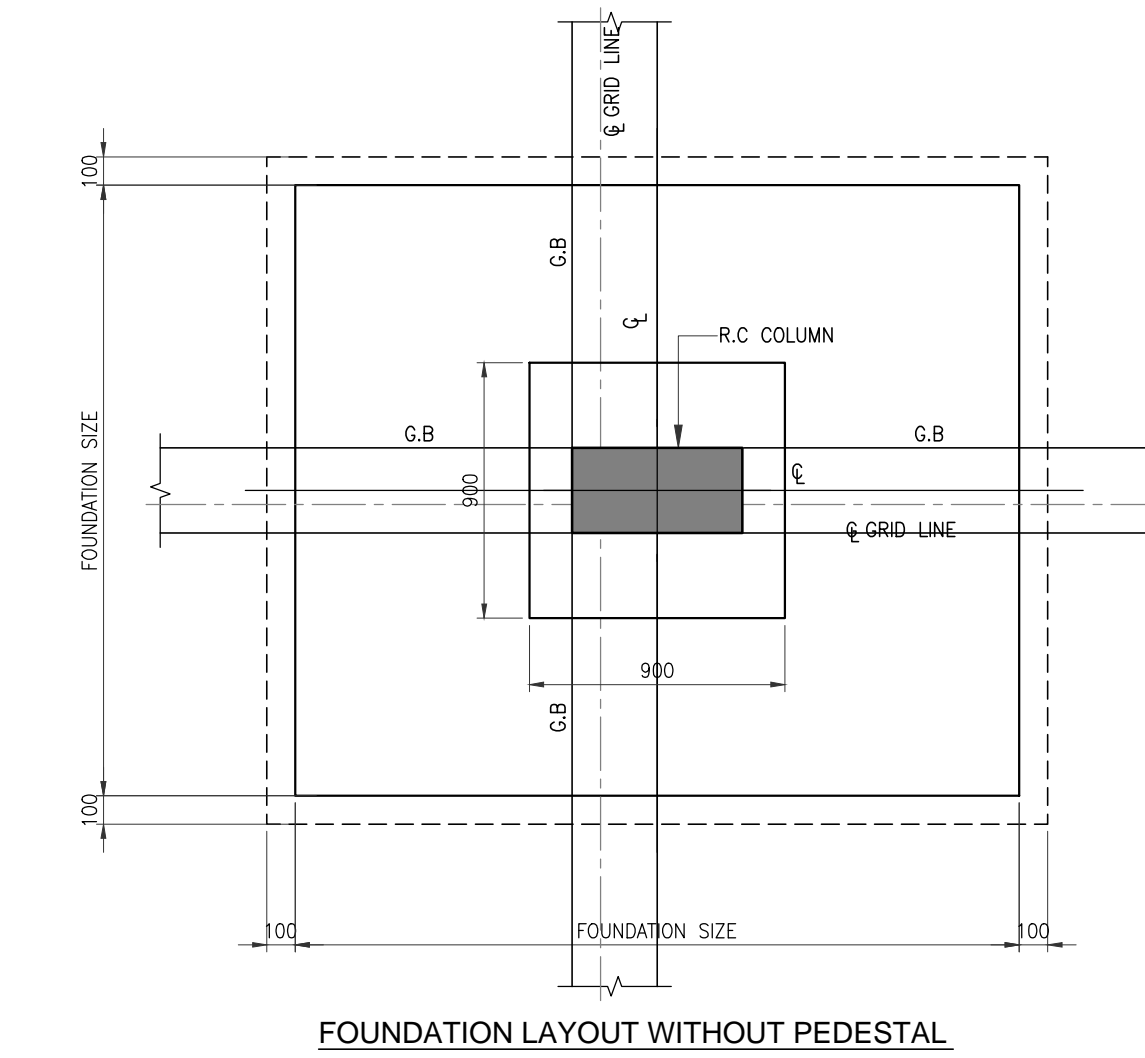
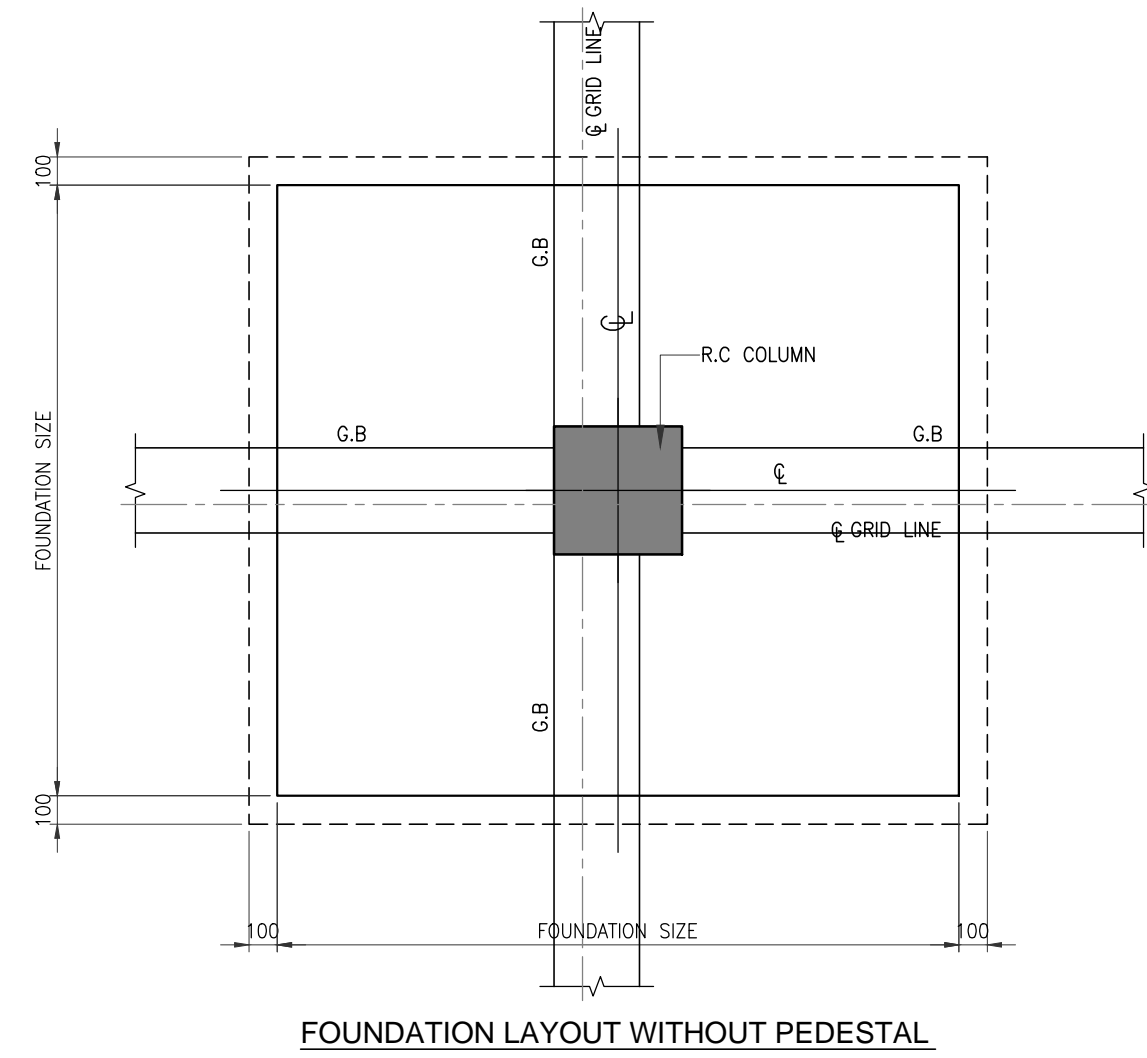
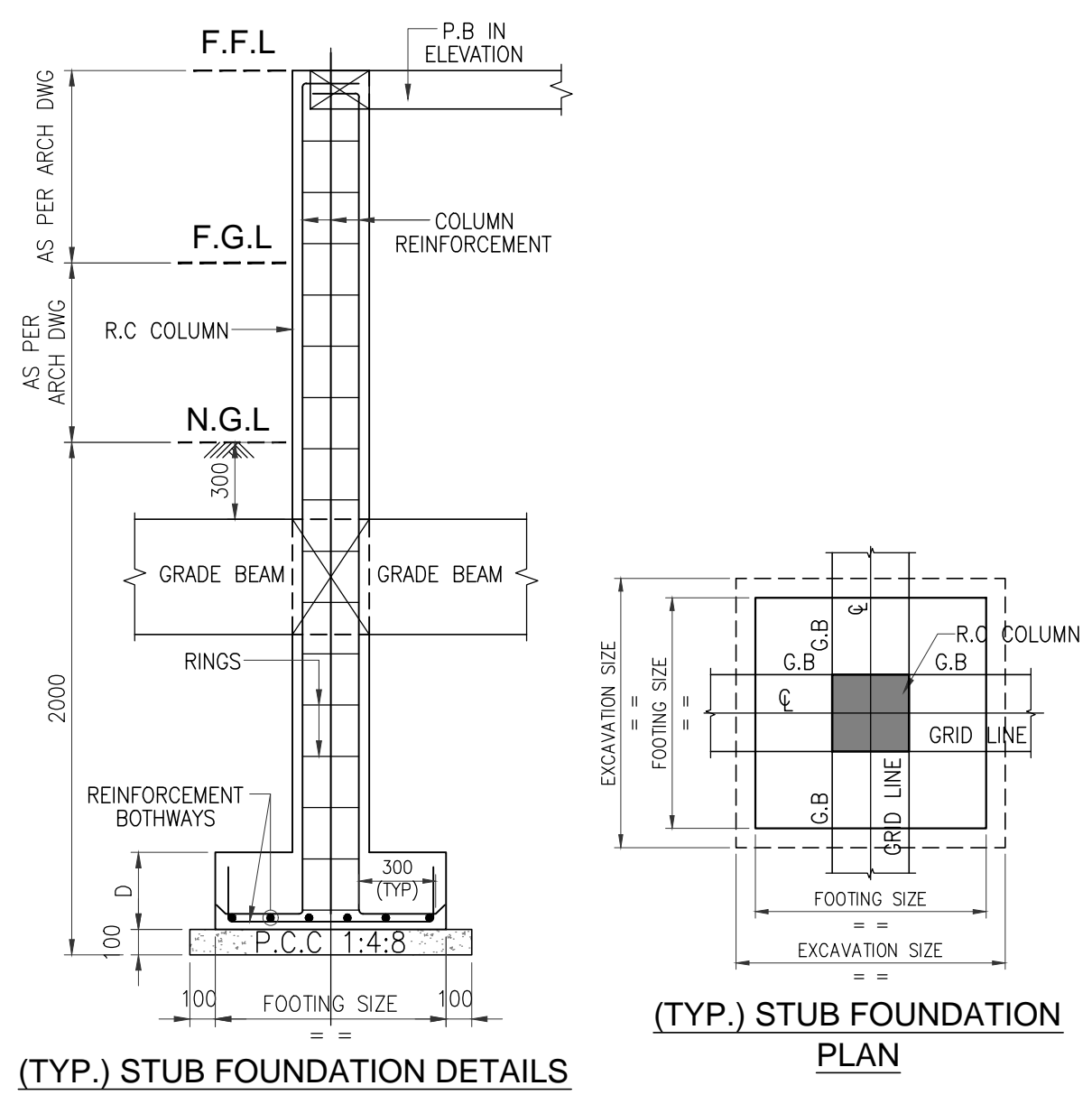
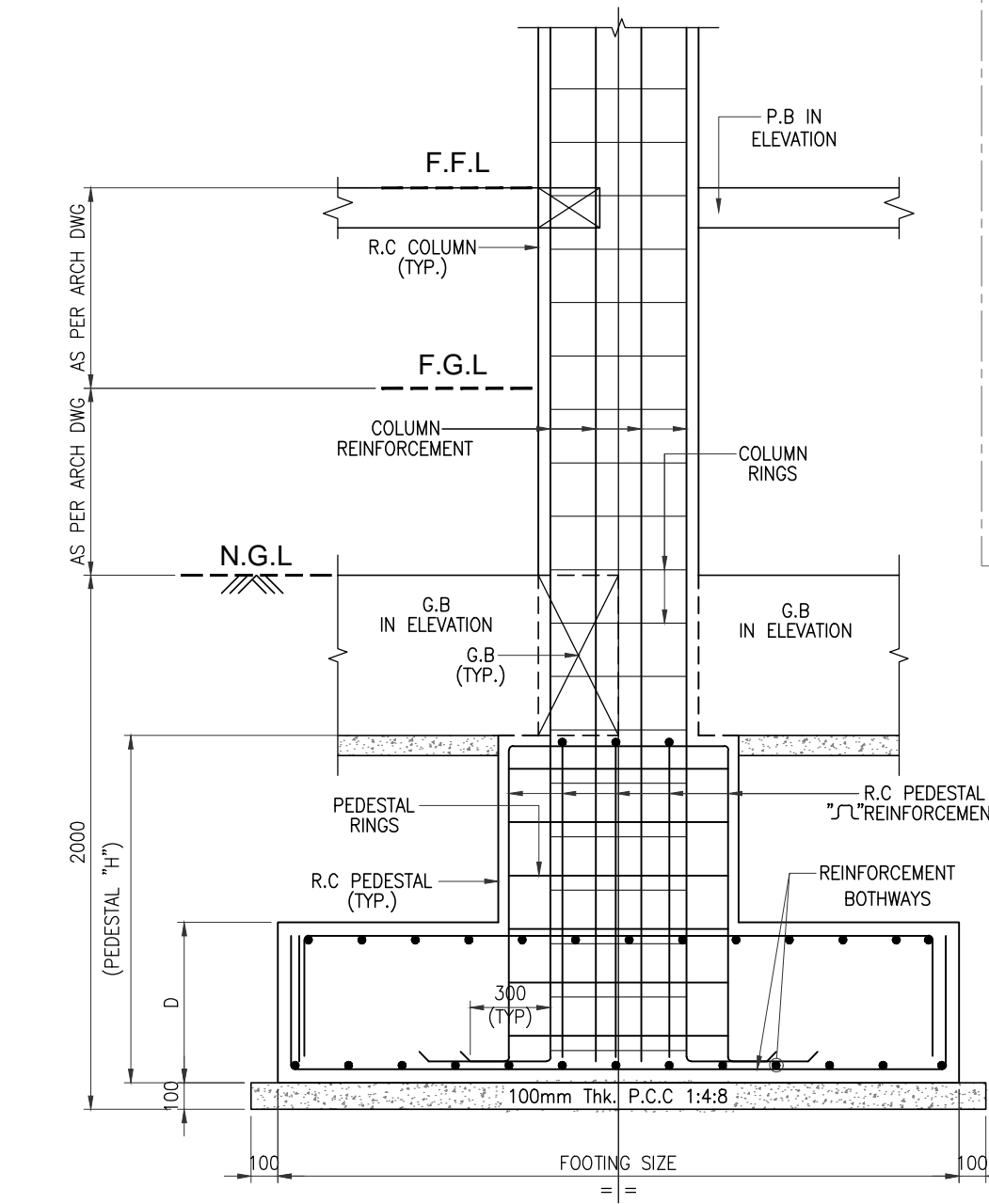
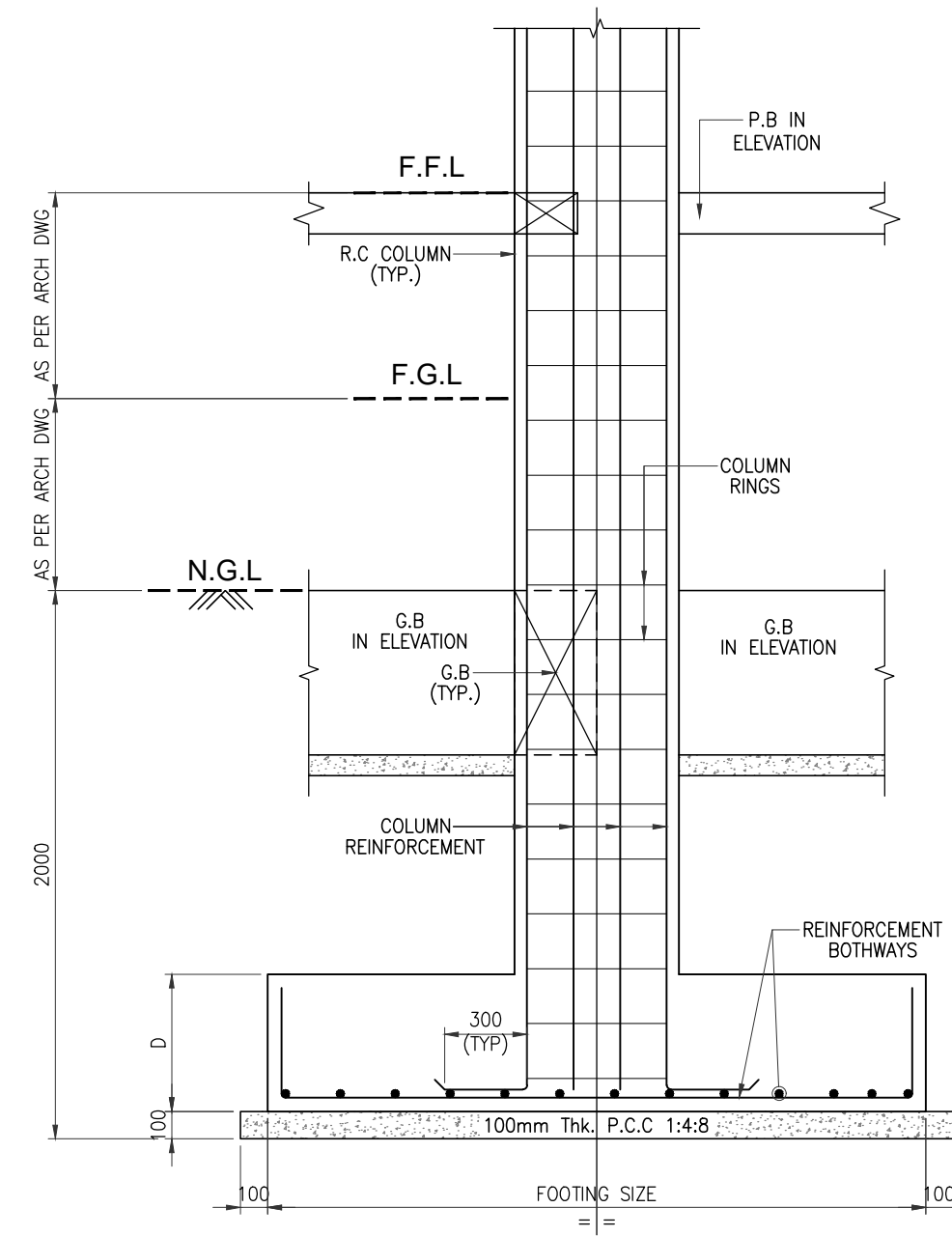
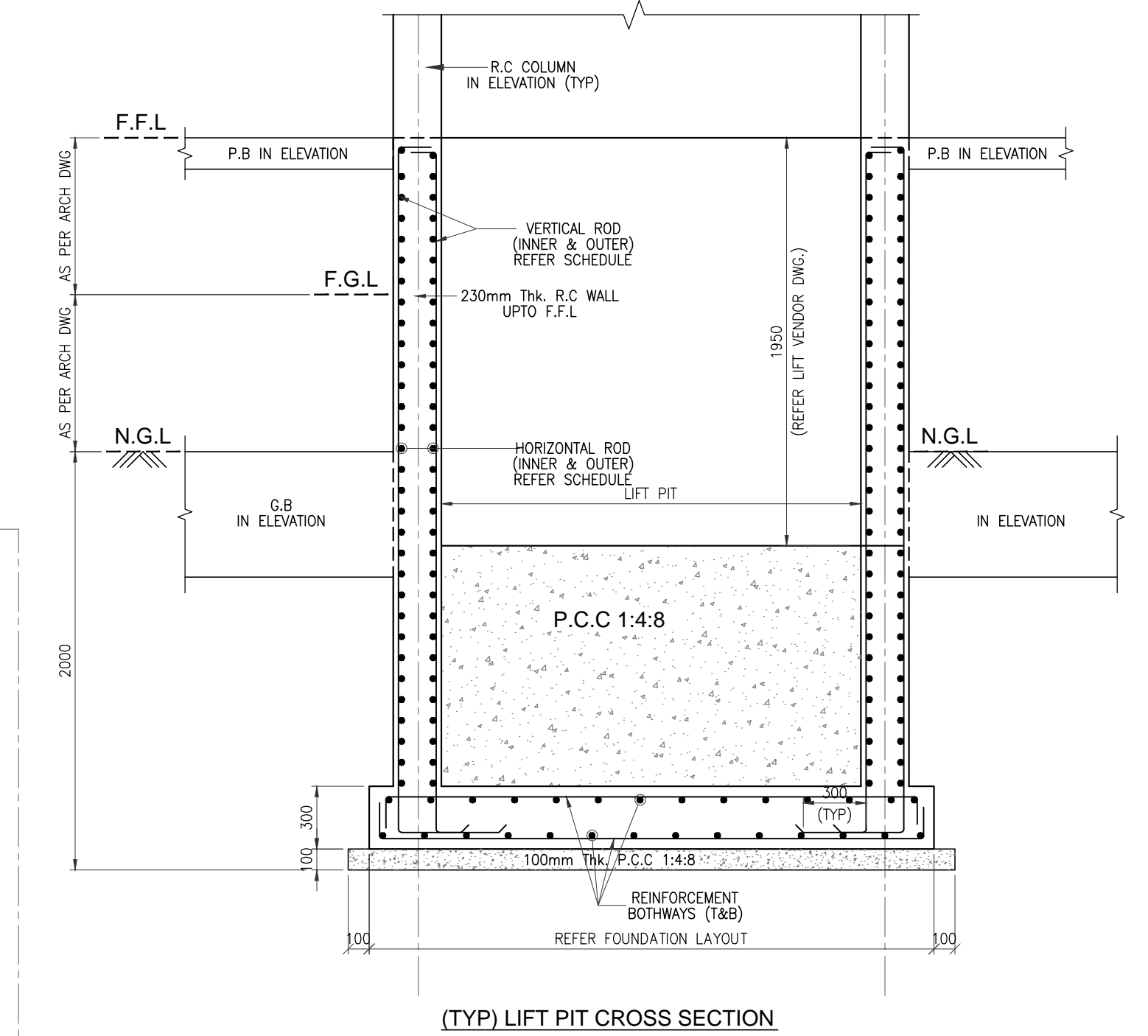

REV.	DATE	DESCRIPTION	DRAWN	CHKD.
REVISIONS				
AS BUILT				
CONSTRUCTION				
APPROVAL				
INFORMATION				
TENDER				
SCHEME				
ISSUED FOR				

TENDER

NAME OF THE PROJECT:
PROPOSED CONSTRUCTION OF INSTITUTIONAL BUILDING FOR M/S. ICAI, Chengalpattu District Branch of SIRC of ICAI

CLIENT:
M/S. INSTITUTE OF CHARTERED ACCOUNTANTS OF INDIA Chengalpattu District Branch of SIRC of ICAI

DRAWING TITLE:
FOUNDATION DETAIL

STRUCTURAL CONSULTANT:
ZACHARIA GEORGE F.I.E

SCALE: 1:25 @ A1	DESIGN BY: ZG	DRAWN BY: KALAISELVI	CHECKED BY: M.MANI
DATE: 03.05.2023	SIGN:	SIGN:	SIGN:

ARCHITECTURE * INTERIORS * PLANNING * ENGINEERING * MANAGEMENT

PITHAVADIAN AND PARTNERS
Chennai • Bengaluru • Kochi • Hyderabad

10, MURUGAPPA ROAD, NAWAB GARDENS, KOTTURPURAM, CHENNAI - 600 085

Phone : +91 (0) 44 2447 0033 / 44 166
Fax : +91 (0) 44 2447 0888 / 4213 2797
email : mail@paparchitect.com
website : www.paparchitect.com